

| PRODUCT NUMBER | PCB THICKNESS |
|----------------------|------------------|
| 91877-001 | 1.6MM |
| 91877-002 | 2.4MM |
| 91877-003 | 2.4MM |
| 91877-001LF | 1.6MM |
| 91877-002LF | 2.4MM |

OBSOLETE USE 91877-002

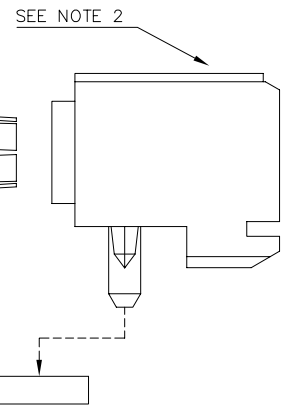
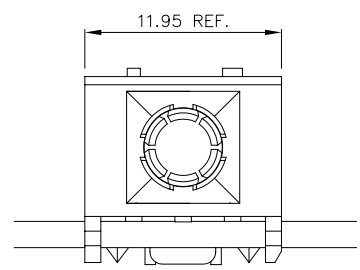
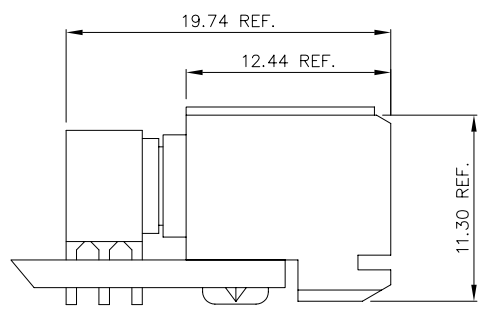
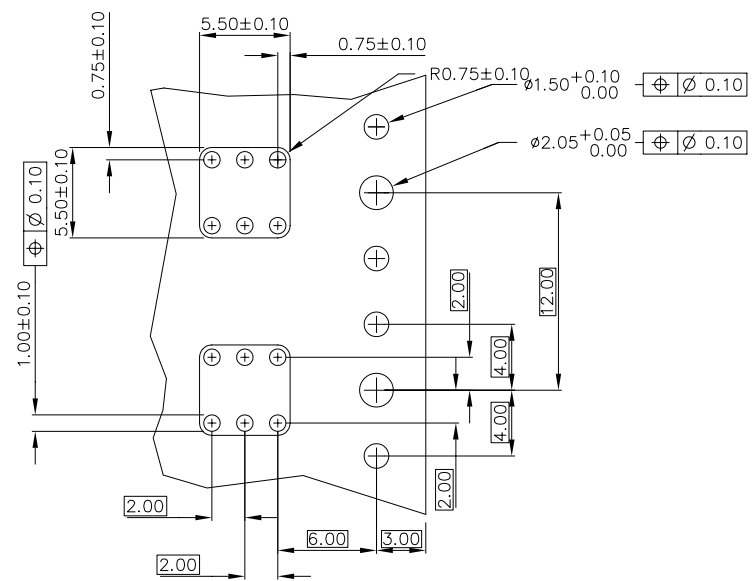
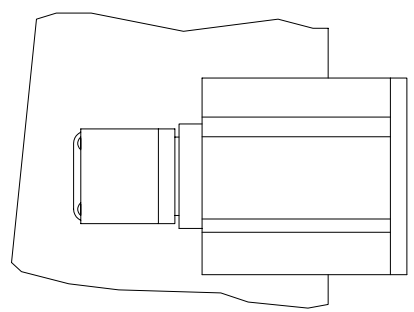

RECOMMENDED HOLE PATTERN
COMPONENT SIDE

NOTE:

- HOUSING SHOWN FOR APPLICATION CLARITY AND DOES NOT COME WITH R.A.RECEPTACLE POWER CONTACT
- 4 ROW HSG W/HEAT STAKE PEG: P/N 70292-101
4 ROW HSG W/PRESS PEG: P/N 89092-101
5 ROW HSG W/HEAT STAKE PEG: P/N 73477-101
5 ROW HSG W/PRESS PEG: P/N 73478-101
- RECEPTACLE CONTACT PLATING:
GOLD OVER NICKEL
- PLATING ON TAILS OF 91877-YYY IS SnPb
PLATING ON TAILS OF 91877-YYLF IS Sn (LEAD FREE)
- IF P/N IS "LF" THE PRODUCT MEETS EUROPEAN UNION DIRECTIVES AND OTHER COUNTRY REGULATION AS DESCRIBED IN GS-22-008.



FCIconnect.com

Copyright FCI

| | | | | | | | | | |
|-------------|----------|------------|----------|---------------------|-------------|---------------------------------------|-------------------------------|----------------|--|
| mat'l. code | | surface | | tolerance | | projection | | product family | |
| - | | ISO 1302 ✓ | | ISO 406 ISO 1101 | | mm | | METRAL (tm) | |
| ltr | | ecn no dr | | date | | tolerances unless otherwise specified | | title | |
| B | v31676 | SCS | 9/08/93 | angles | linear | xx ±.01/3 | R.A. PASS-THRU POWER CONTACT | | |
| C | v60188 | CSC | 2/02/96 | σ±2' | | xxx ±.005/.13 | scale 1:1 | | |
| D | v01818 | JWS | 7/17/00 | | | xxxx ±.0020/.050 | sheet 1 of 1 size | | |
| E | v02928 | JWS | 12/12/00 | dr | STU STONER | 11/01/91 | A3 | | |
| F | v04-1176 | TAB | 12/14/04 | enr | R. DOUTRICH | 11/01/91 | 91877 | | |
| G | M06-0156 | MHT | 4/13/06 | chr | STU STONER | 11/01/91 | type Product Customer Drawing | | |
| H | M06-0286 | MNR | 7/27/06 | appd | STU STONER | 11/01/91 | | | |
| sheet | revisor | H | | | | | | | |
| index | sheet | 1 | | | | | | | |

form: A3